



**RP - Sanjiv Goenka
Group**
Growing Legacies



**EXCLUSIVE INTERVIEW: NETFLIX CEO
TED SARANDOS ON THE WARNER BROS. BID**

JANUARY 2026 • FORTUNEINDIA.COM

FORTUNE

INDIA



**BEST
INVESTMENTS
2026**
**PRE-BUDGET
SPECIAL**

BELA BAJARIA
CHIEF CONTENT
OFFICER, NETFLIX

MONIKA SHERGILL
VICE PRESIDENT,
CONTENT,
NETFLIX INDIA

**NETFLIX'S
INDIA
DECADE**

**A TALE OF
PREMIUM CONTENT
AND MASS
SUBSCRIBERS**



Architecture That Outlast the Moment

In a time when architecture is often driven by velocity and spectacle, Habitat Architects works with a different rhythm.

Zafar Choudhary, Founding Partner and CEO and
Monika Choudhary, Co-Founder and Chief Development Officer, Habitat Architects

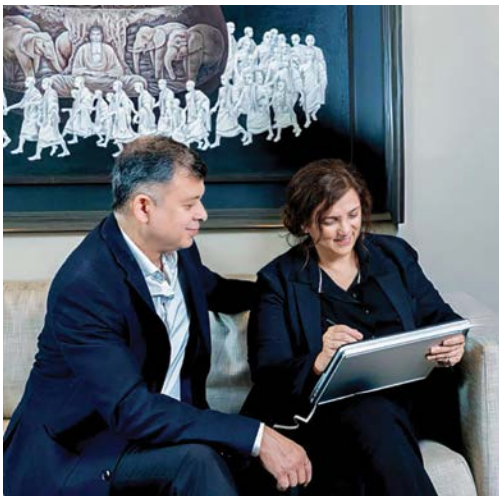

What defines architecture is not how it is perceived on day one, but how it performs decades later.

- Zafar Choudhary

how people move through it, gather within it, and continue to return.”

This long-view thinking underpins the studio’s work across residential, hospitality, and large civic-commercial developments. Rather than designing singular statements, Habitat places emphasis on movement, proportion, and human scale. Streets are prioritized over façades. Plazas are conceived as social extensions rather than decorative forecourts. Walkability, clarity, and comfort quietly anchor the masterplan.

Habitat’s process begins less with form and more with observation—of climate, cultural rhythms, and everyday patterns of use. Classical urban principles reappear through a

Led by Founding Partner and CEO Zafar Choudhary and Co-Founder and Chief Development Officer Monika Choudhary, the practice has spent decades shaping environments that prioritise lived experience over momentary visual impact. For Habitat, architecture is not an object to be admired from afar. It is a framework within which daily life unfolds.

“What ultimately defines architecture,” says Zafar, “is not how it is perceived on day one, but how a place performs ten or twenty years later—

Design becomes meaningful when narrative, culture, and functionality evolve together.”

- Monika Choudhary





Night View, Plaza

contemporary lens: shaded arcades that respond to heat, courtyards that allow pause, and promenades that encourage informal social life. These are not nostalgic gestures, but precise spatial tools deployed to create legibility and continuity within fast-growing cities.

“Mindful architecture does not demand instruction,” reflects Monika. “When spaces are planned with care, people intuitively understand how to inhabit them.”

Her grounding in sociology and design strategy plays a critical role in shaping the studio's approach. Narrative is not applied after the fact—it evolves alongside planning, aligning commercial intent with cultural relevance and long-term usability. The result is architecture that remains resilient beyond launch, adapting gracefully as cities grow around it.

What distinguishes Habitat's work is contextual intelligence rather than a fixed stylistic signature. Each project responds carefully to its geography, density, and urban condition. Public realms transition into quieter edges. Retail streets dissolve into shaded courts and internal squares. Landscape functions as spatial infrastructure—guiding movement, tempering scale, and offering moments of relief within dense environments.

Rather than isolated icons, Habitat Architects designs urban ecosystems—places structured to mature, evolve, and continue to feel relevant with time.

“There is discipline in restraint,” says Zafar. “When planning is rigorous and proportion is right, longevity follows naturally.”



Night View, Luxury Resort

“When planning is rigorous and proportion is right, longevity follows naturally.”

— Zafar Choudhary

Habitat also stands apart as a legacy-driven practice. Built around continuity of values rather than aesthetic cycles, the firm reflects a rare alignment between architectural clarity and strategic growth. Zafar's leadership in spatial planning forms the structural backbone of the practice, while Monika's stewardship shapes its broader trajectory—guiding positioning, growth, and cultural articulation.

Together, they have established a studio trusted for depth, calm authority, and long-term thinking—qualities increasingly essential in rapidly transforming Indian cities.

As Habitat Architects continues to expand nationally, its philosophy remains steady. Architecture, for practice, is an act of responsibility—to land, to people, and to time itself.

In a world eager for instant icons, Zafar and Monika Choudhary are building something quieter, and far more enduring: places designed not just to be seen, but to be lived in. ■



Residential Elevational View

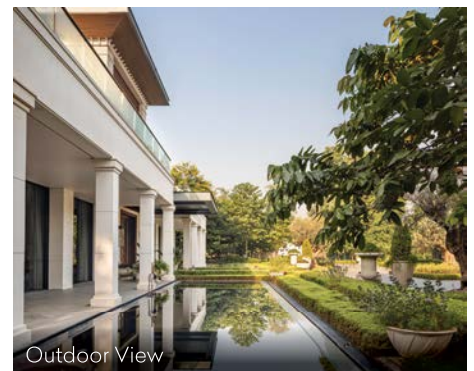

Outdoor View

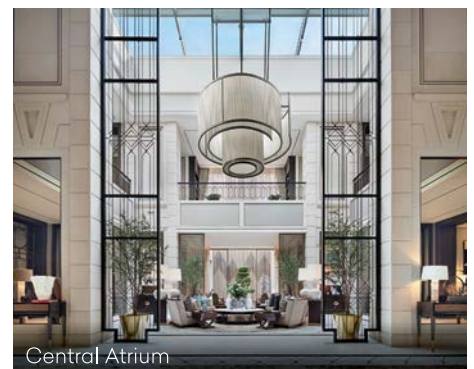

Central Atrium

Contact us at

design@habitatarc.com | www.habitatarc.com

Instagram - @zafar.habitat